

# Oregon Writing & English Advisory Committee



## **OWEAC Quarterly Meeting**

October 21, 2016  
8:30 a.m. – 4:00 p.m.

## **Oregon State University**

Memorial Union, Room 211  
Corvallis, Oregon

[Directions to Campus](#)

[Parking](#)

[Hilton Garden Inn](#)

[Other Accommodations](#)

[Campus Map](#)

[Memorial Union Map](#)

[Restaurants](#)

*See detailed info below*

## **OSU Writing Intensive Curriculum Program**

Oregon State University  
306 Waldo Hall, Corvallis, Oregon 97331  
Phone: 541-737-3711  
E-mail: [Vicki Tolar Burton](mailto:Vicki.Tolar.Burton)  
[WIC Website](http://wic.oregonstate.edu) (wic.oregonstate.edu)

## Driving Directions

- From I-5, take Exit 228.
- Turn west onto Highway 34 towards Corvallis/Newport.
- Continue on OR-34 for about 10 miles.
- Take the OR-34 exit, Exit 228, toward Corvallis.
- Turn right onto OR-34 toward Corvallis/Newport.
- Continue on OR-34 for about 10 miles.
- Turn left onto OR-34 Bypass/Corvallis-Newport Hwy. toward Philomath/Newport/Reser Stadium (At the light right before going over the bridge into Corvallis).
- Continue on OR-34 for about 2 miles (Hwy. 20/34/Philomath Blvd.)
- Turn right onto 26th Street.
- Proceed to next intersection. The Hilton Garden Inn will be on your right for those staying there. Across Western Blvd., on the left, is the Reser Stadium parking lot, where many of you will park. The Memorial Union is just a few blocks north, at the corner of 26th Street and SW Jefferson Way. At the link [here](#), the bottom blue marker shows the location of the Hilton Garden Inn; to the left of the next marker up is the Reser Stadium parking lot; and the Memorial Union is located where you see the words “OSU National Historic District” above the words “Oregon State University,” or see maps below.

## Parking

Parking permits are required between 7:00 a.m. and 5:00 p.m., Monday through Friday, year-round. View [campus parking map](#).

- You can purchase an all-day parking permit for \$10 (Zones B & C). To purchase a permit online, visit [OSU Parking Services](#). You will receive an email with a PDF of your permit, which you will need to print out, bring with you, and place on the driver’s side dashboard of your car.
- You can also purchase an all-day parking permit in any lot with a Pay Station. The Pay Stations accept cash and credit cards.
- The best parking options are the parking structure located on the corner of 26th Street and Washington Way, with pay stations on the first three floors (note, enter off 26th St., just north of the CH2m Alumni Center) and the Reser Stadium parking lot (see [map](#)). Both locations offer just over a block’s walk north on 26th Street to the Memorial Union.
- Visitor ADA parking spaces require both an OSU parking permit and a valid DMV placard. Visitors to campus with a valid ADA placard may obtain a three-hour guest permit at no charge at the Parking Office, located at 606 SW 15<sup>th</sup> Street (100 Adams Hall). With a valid DMV placard, you may park at any meter that has a limit of more than 30 minutes without payment.

## **Lodging**

The [Hilton Garden Inn](#) is located just south of the OSU campus at 2500 SW Western Blvd., and is within walking distance to the Memorial Union building, or you can take the east route Beaver Bus (purple route on the attached [map](#)) or else walk a block to the LaSells Stewart Center and catch the west route 1 Beaver Bus (light gold route on the attached [map](#)) to the MU at the corner of 26th Street and SW Jefferson Way. For reservations, call 541-752-5000.

You can also explore alternate accommodations on the [Visit Corvallis](#) website.

## [Campus / Parking Map](#)

## [Memorial Union Map](#)

Room 211 is on the southeast side of the Memorial Union, on the second floor. If you're not familiar with the Memorial Union, enter off of SW Jefferson, near where the handicap ramp is. After the foyer, where the ATM machine is, there'll be an elevator on your right. Take the elevator to the second floor. Room 211 is all the way down the hall at the west end of the building (see map on following page).

Or you could enter the MU at the corner of 26<sup>th</sup> Street and SW Jefferson Way. This is the food court area. Head to the north side of the building and follow the hallway to the main stairs. Once on the first floor, head to the east end of the building and take the stairs or elevator to the second floor. Room 211 is all the way down the hall at the west end of the building.

## **Meals / Restaurants**

Continental breakfast and coffee will be provided at the meeting. Lunch will be on your own. While the [Visit Corvallis](#) website lists a large number of restaurants in the Corvallis area, look for the ones on Monroe Street, which is just a short walk north of the Memorial Union. You'll also find a number of restaurants within the Memorial Union building in the food court area located in the southwest corner of the first floor. Pangea is located in the north hallway near the food court area, and North Porch is located in the northeast corner of the first floor.

## **Wireless**

OSU offers guests wireless connectivity. To login, click on your wireless icon and choose "Visitor." You will need to re-connect every two hours.

# WELCOME TO THE MEMORIAL UNION

26th St.



## 2

SECOND FLOOR

Meeting Room

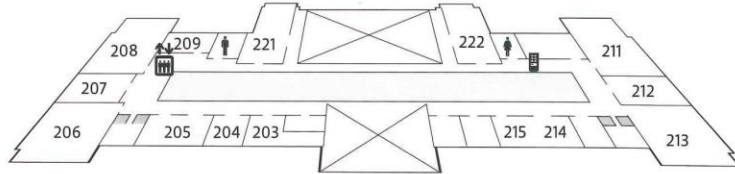

## 1

FIRST FLOOR

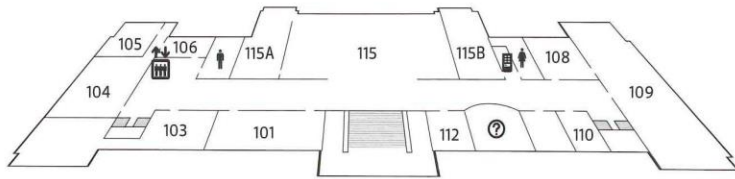

## M

MEZZANINE

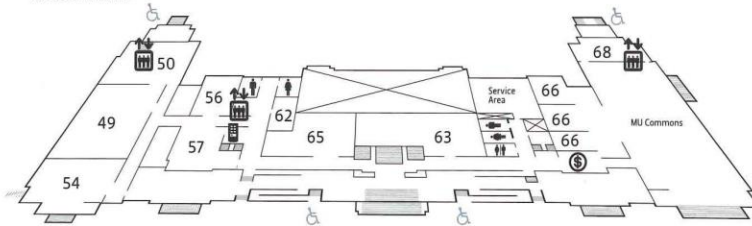

## G

GROUND FLOOR

2501 SW Jefferson Way

Enter here

to Jefferson St





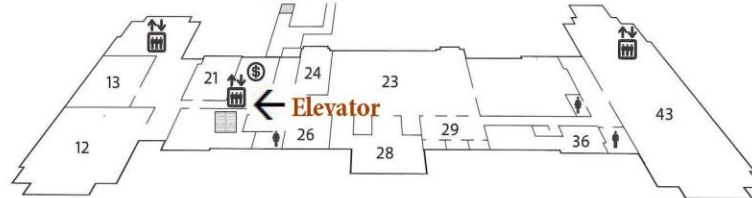



Elevator

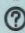

Quad

Room names on back

Oregon State  
UNIVERSITY

-  Mens Bathroom
-  Womens Bathroom
-  Information Desk
-  ATM Machine
-  Elevator
-  Vending Machine